

A close-up photograph of green leaves and brown branches, likely from a tree or shrub, filling the background. The leaves are elongated and have a slightly serrated edge. The branches are thin and brown. The lighting is bright, creating strong shadows and highlights on the leaves.

# **495 FOURTH AVENUE, AUSTRAL NORTH**

## **LANDSCAPE DA DOCUMENTATION**

**GROUND ĪNK**  
LANDSCAPE ARCHITECTS

# 01. LOCAL ECOLOGY CONTEXT

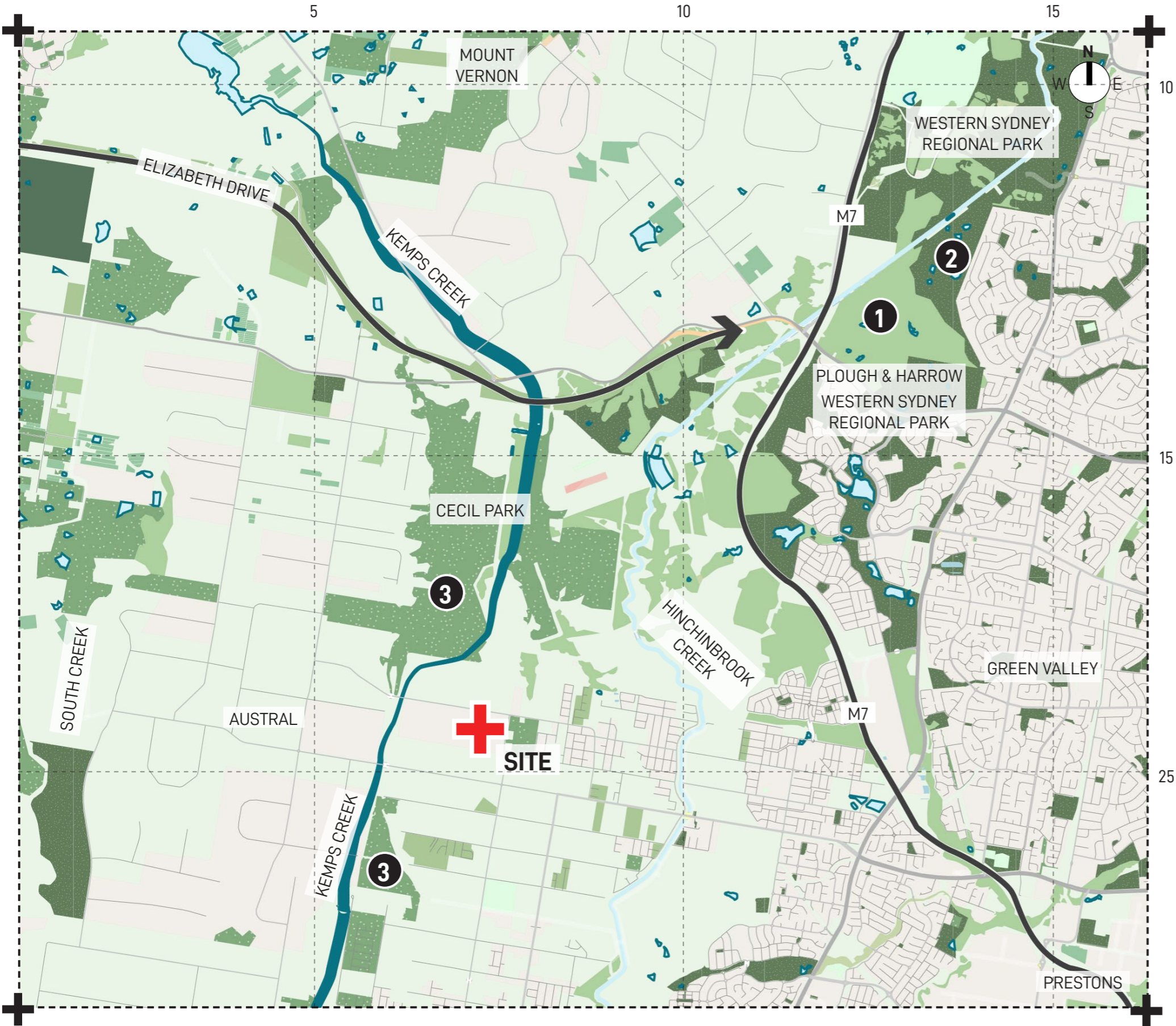

## SHALE PLAINS WOODLAND

GREY BOX AND FOREST RED GUM, WITH NARROWLEAVED IRONBARK, THIN LEAVED STRINGYBARK AND SPOTTED GUM OCCURRING LESS COMMONLY IN THE TREE LAYER. MAINLY OCCURRING ON SOILS DERIVED FROM WIANAMATTA SHALE.



## CUMBERLAND PLAIN WOODLAND

THE ENDANGERED ECOLOGICAL COMMUNITY ALONG KEMPS CREEK IS DOMINATED BY EUCALYPTUS CREBRA, EUCALYPTUS EUGENIODES, ACACIA IMPLEXA, ACACIA FALCATA, SPOTTED GUM

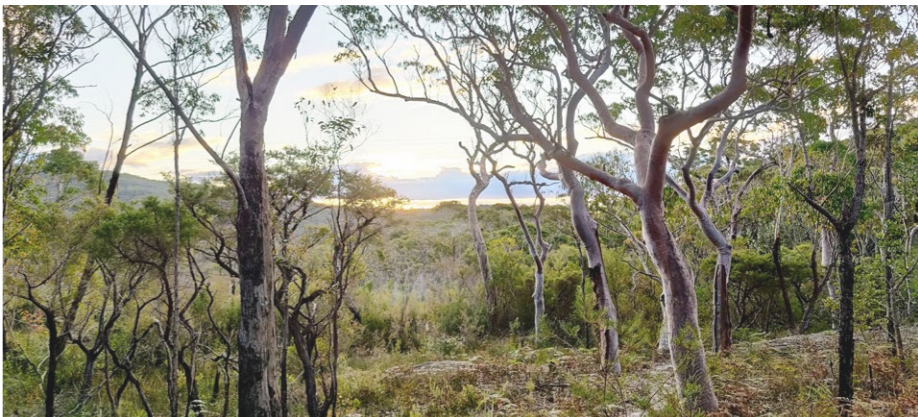

## SHALE HILLS WOODLAND

GREY BOX, FOREST RED GUM, NARROW-LEAVED IRONBARK WOODLAND WITH LOW DENSITIES OF SPOTTED GUM LOCATED ON THE SHALE HILLS.

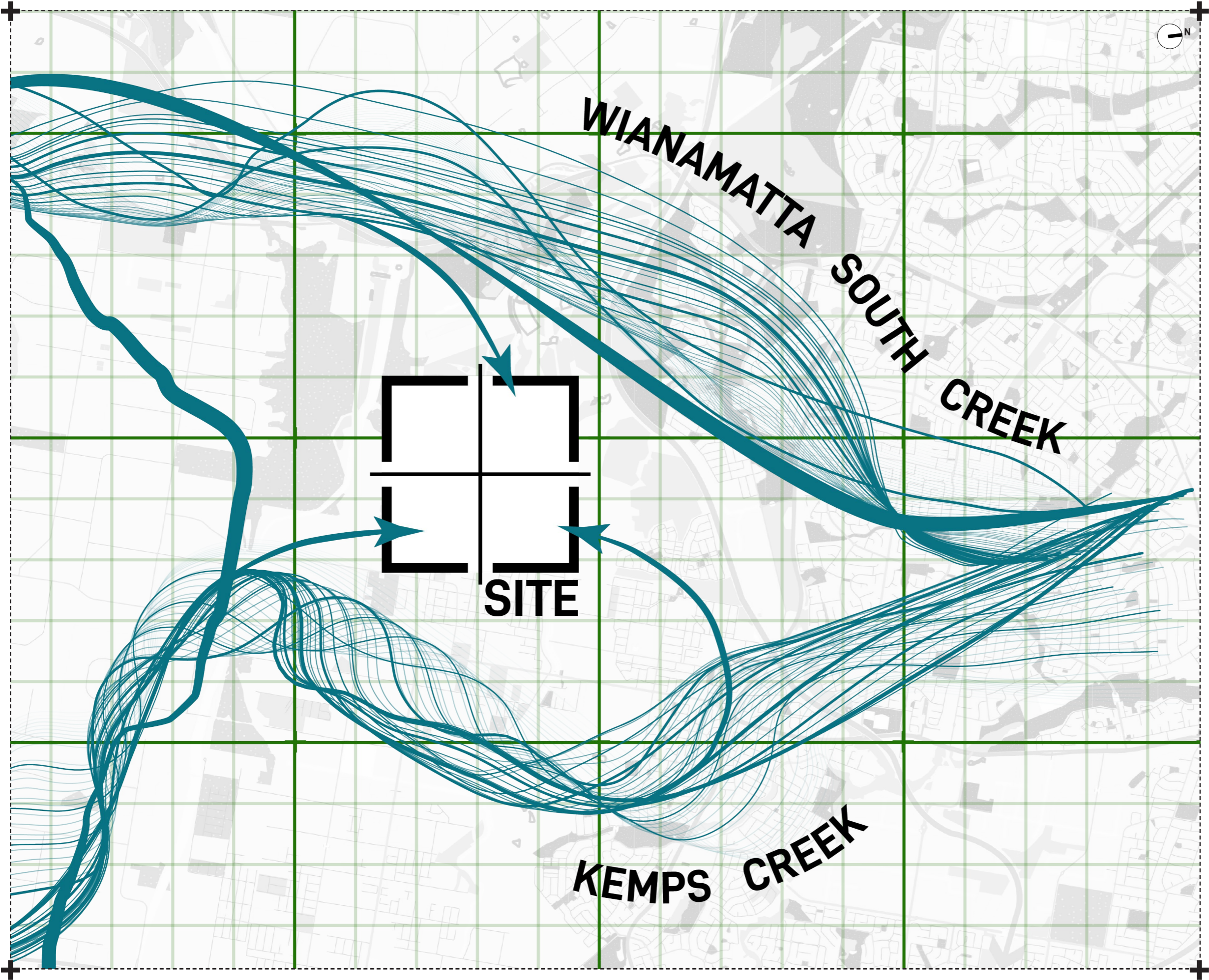

DESIGN CONCEPT

The driving concept behind the landscape design approach has been to connect the site to its wider context. Austral is characterised by the agricultural grid system, and remnant Cumberland Plain vegetation which predominantly follows the tributary creek systems running north to south. The two main tributaries close to the site are Wianamatta South Creek (to the West) and Kemps Creek (also to the West, and North of the site).

The design aims to draw upon the surrounding natural context in subtle ways, to use locally sourced materials, and to also reflect the agricultural history and character of the area.

## 03. LANDSCAPE MASTERPLAN

SCALE 1:400 @ A3

0 2 4 6 8 12m

| | | | |

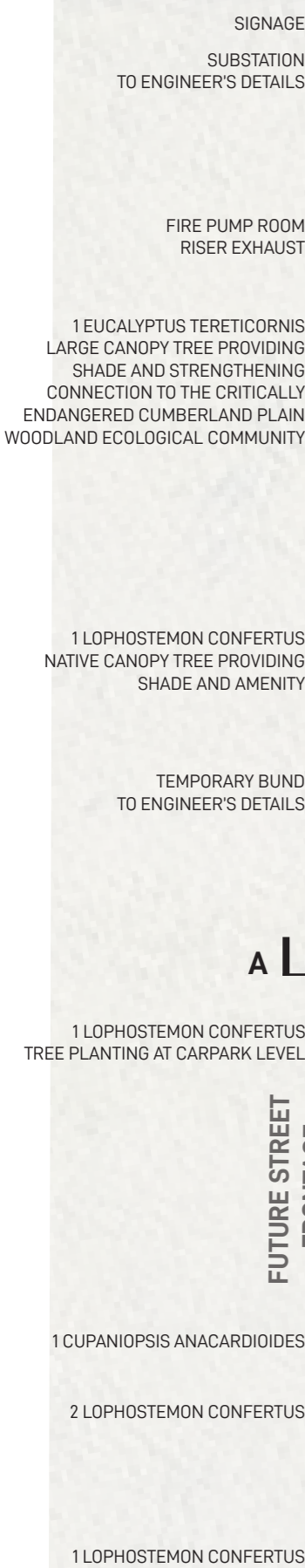

# 04. UPPER LEVEL MALL - NORTH

KEY



LEGEND

- 1 BENCH SEATING
- 2 INTERIOR DINING AREA

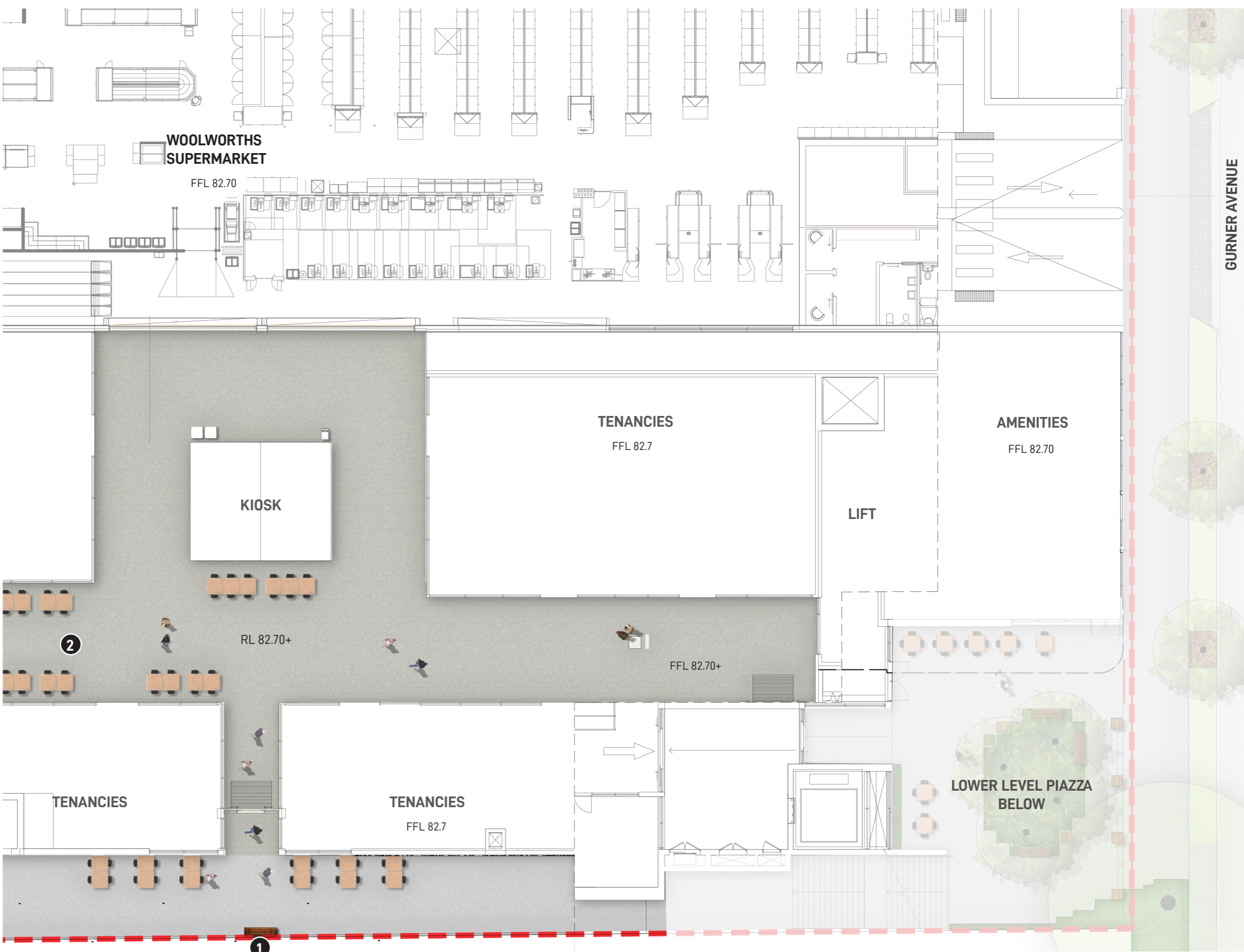

# 05. SOUTH EAST CORNER

KEY

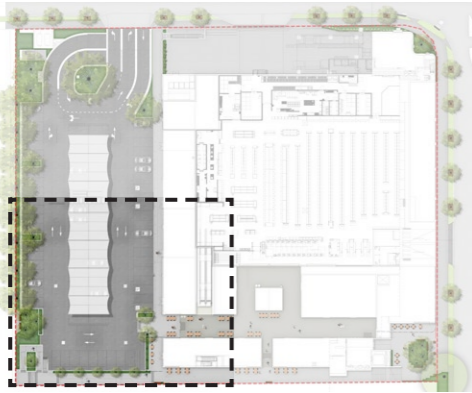

LEGEND

- 1 RAISED PLANTERS WITH MIXED PLANTING
- 2 NATIVE CANOPY TREES WITHIN RAISED PLANTERS ON SLAB TO OFFER SHADE TO CAR PARK. MINIMUM 1.2 METRES OF SOIL DEPTH REQUIRED
- 3 SMALL NATIVE CANOPY TREES IN RAISED ON SLAB PLANTER
- 4 ALFRESCO DINING
- 5 POCKET PARK AT FUTURE STREET LEVEL
- 6 TREE PLANTING AT CARPARK LEVEL

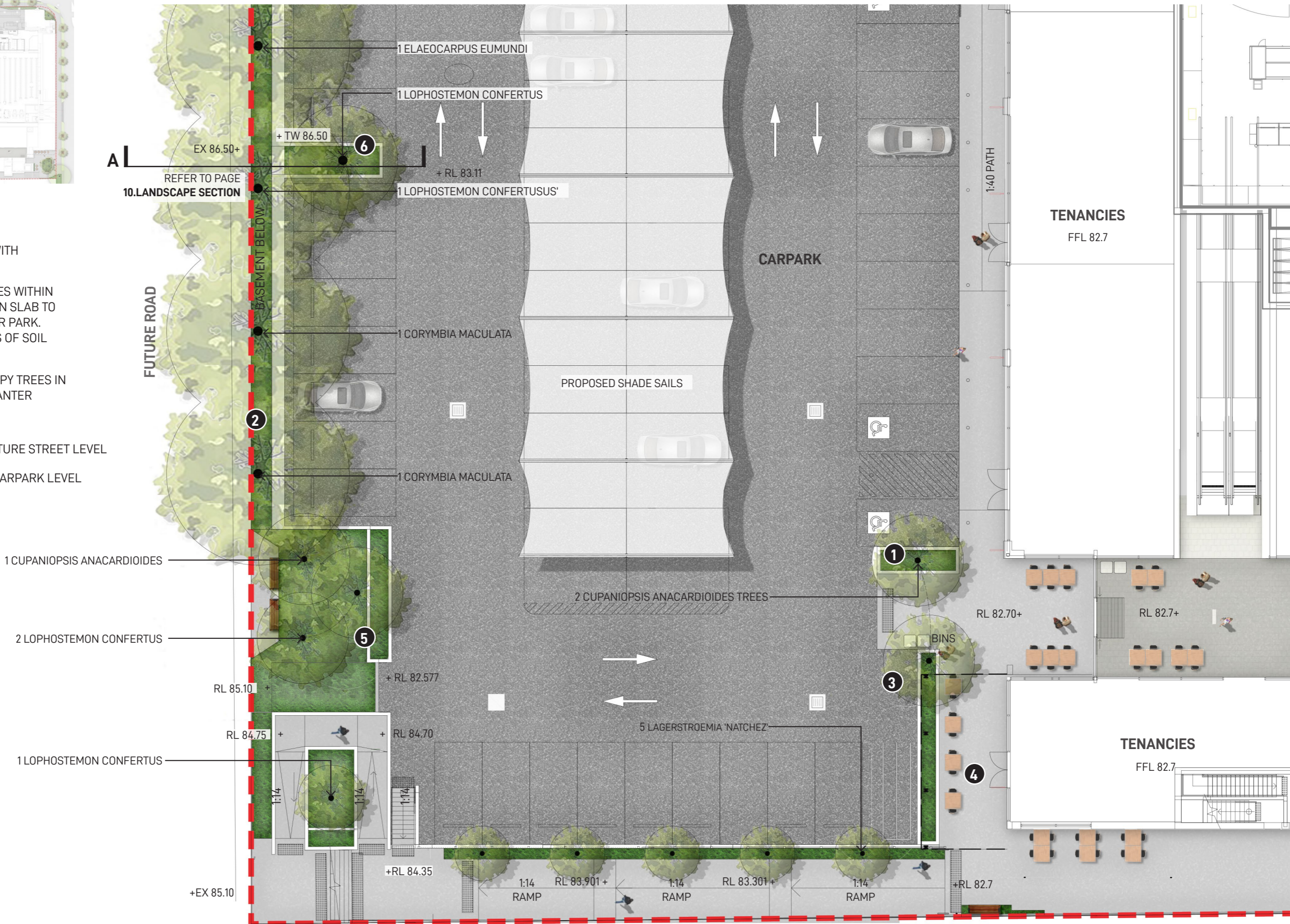

# 06. CARPARK - SOUTH WEST

KEY



LEGEND

- 1 RAISED ON PODIUM PLANTING AREAS WITH MIXED PLANTING
- 2 LARGE NATIVE CANOPY TREE TO OFFER SHADING AND BUFFERING TO CAR PARK
- 3 NATIVE CANOPY TREES WITHIN RAISED PLANTERS ON SLAB TO OFFER SHADE TO CAR PARK. MINIMUM 1.2 METRES OF SOIL
- 4 RAISED PLANTER ON SLAB, ABOVE LOADING DOCK TO ALLOW FOR LOW MAINTENANCE SHRUBS WITH CASCADE PLANTING
- 5 TREE PLANTING AT CARPARK LEVEL



# 07. NORTH - WEST FRONTAGE

KEY

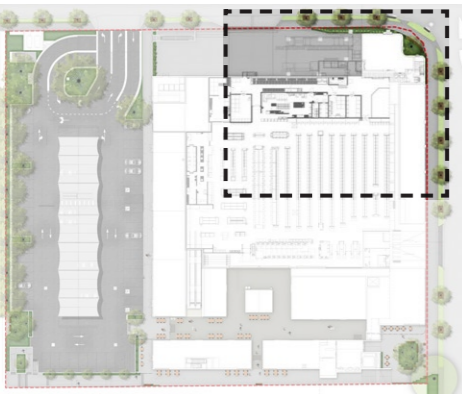

LEGEND

- 1 NATIVE HEDGING TO SCREEN BUILDING
- 2 BENCH SEATING



# 08. LOWER GROUND PIAZZA

KEY



LEGEND

- 1 SEATING BOLLARDS
- 2 MEDIUM TREES WITH SHADED SEATING BELOW
- 3 ALFRESCO DINING AREAS



INDICATIVE PLANT IMAGES

CUMBERLAND WOODLAND TREES



LIVERPOOL COUNCIL TREES

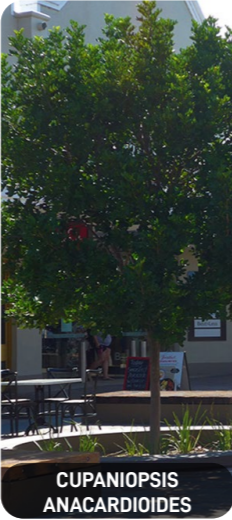

SHRUBS



SHRUBS, GRASSES & GROUNDCOVERS



PLANT SCHEDULE

| BOTANICAL NAME (COMMON NAME)               | MATURE HEIGHT | NATIVE | CUMBERLAND<br>PLAIN<br>WOODLAND | POT SIZE | QUANTITY |
|--------------------------------------------|---------------|--------|---------------------------------|----------|----------|
| TREES                                      |               |        |                                 |          |          |
| BRACHYCHITON POPULNEUS (KURRAJONG)         | 12-15M        | ✓      |                                 | 200L     | 1        |
| CUPANIOPSIS ANACARDIOIDES (TUCKEROO)       | 6-12M         | ✓      |                                 | 200L     | 5        |
| CORYMBIA MACULATA (SPOTTED GUM)            | 15-30M        | ✓      | ✓                               | 200L     | 17       |
| ELAEOCARPUS EUMUNDI (EUMUNIDI QUANDONG)    | 12-15M        | ✓      |                                 | 200L     | 4        |
| EUCALYPTUS TERETICORNIS (FOREST RED GUM)   | 18-20M        | ✓      | ✓                               | 200L     | 1        |
| LAGERSTROEMIA 'NATCHEZ' (CREPE MYRTLE)     | 5-7M          | ✓      |                                 | 45L      | 5        |
| LOPHOSTEMON CONFERTUS (BRUSH BOX)          | 12-15M        | ✓      |                                 | 200L     | 8        |
| ULMUS PARVIFOLIA (CHINESE ELM)             | 6-10M         |        |                                 | 200L     | 4        |
| SHRUBS                                     |               |        |                                 |          |          |
| SYZIGIUM 'SUBLIME'                         | 3M            | ✓      |                                 | 45L      | -        |
| INDIGOFERA AUSTRALIS (AUSTRAL INDIGO)      | 2M            | ✓      | ✓                               | 300MM    | -        |
| WESTRINGIA FRUTICOSA (COASTAL ROSEMARY)    | 1.5M          | ✓      |                                 | 200MM    | -        |
| GRASSES & GROUNDCOVERS                     |               |        |                                 |          |          |
| BANKSIA 'BIRTHDAY CANDLES'                 | 0.5M          | ✓      |                                 | 200MM    | -        |
| DIANELLA REVOLUTA (BLUE FLAX LILY)         | 0.4M          | ✓      | ✓                               | 200MM    | -        |
| DOODIA ASPERA (AUTUMN FERN)                | 0.4M          | ✓      |                                 | 200MM    | -        |
| DICHONDRA REPENS (KIDNEY WEED)             | 0.2M          | ✓      | ✓                               | 140MM    | -        |
| HIBBERTIA SCANDENS (GUINEA FLOWER)         | 0.4M          | ✓      |                                 | 200MM    | -        |
| HARDENBERGIA VIOLACEA (FALSE SARSAPARILLA) | 0.4M          | ✓      | ✓                               | 200MM    | -        |
| IMPERATA CYLINDRICA (COGON GRASS)          | 0.6M          | ✓      |                                 | 200MM    | -        |
| JUNCUS USITATUS (COMMON RUSH)              | 0.6M          | ✓      | ✓                               | 200MM    | -        |
| PRATIA PURPURASCENS (PURPLE PRATIA)        | 0.3M          | ✓      | ✓                               | 140MM    | -        |
| THEMEDA AUSTRALIS (KANGAROO GRASS)         | 0.5M          | ✓      | ✓                               | 200MM    | -        |

10. LANDSCAPE SECTION

SCALE 1:50 @ A3

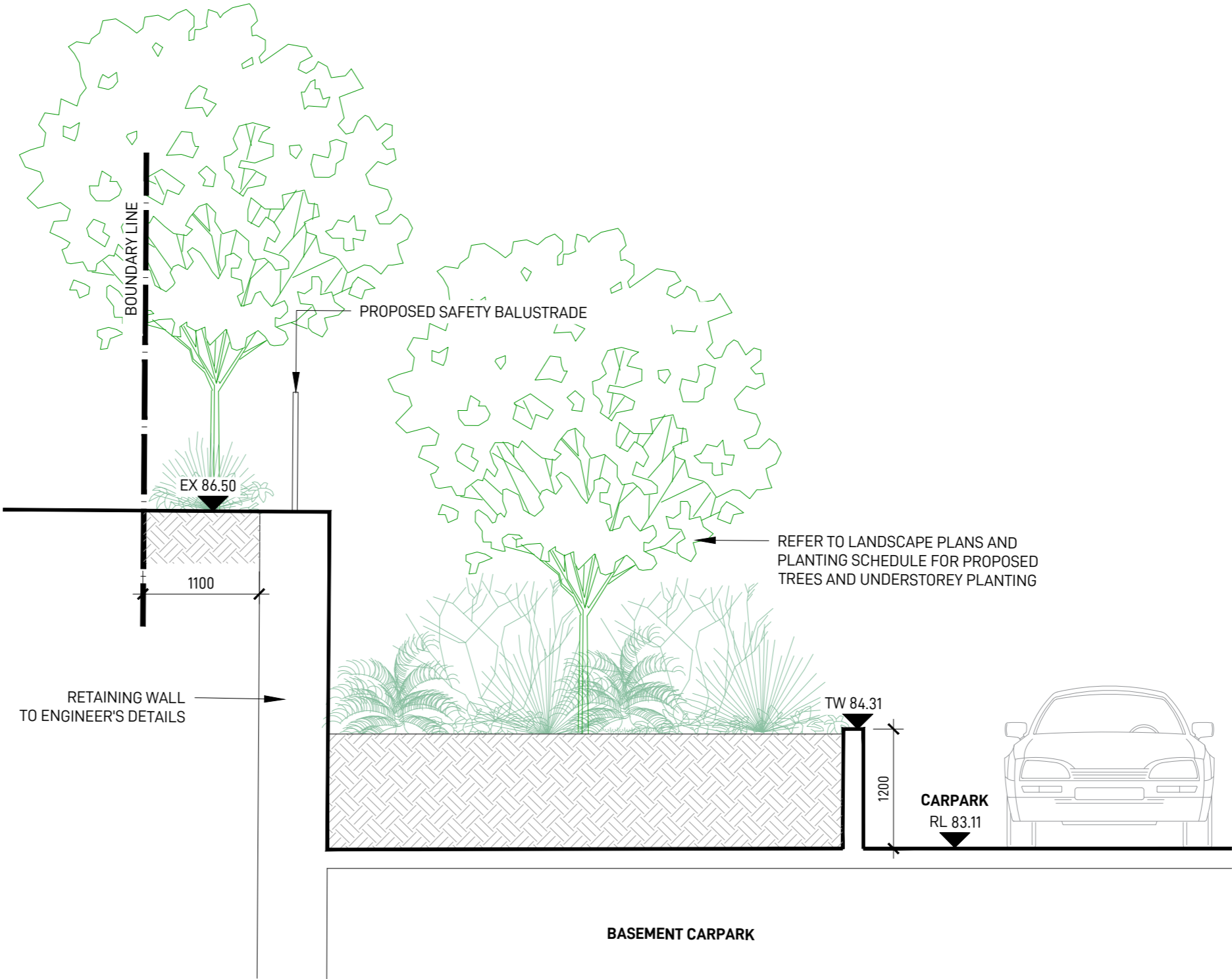
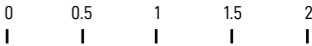

LANDSCAPE SECTION A  
SCALE 1:50

# 11. TREE CANOPY COVERAGE DIAGRAM

SCALE 1:400 @ A3  
0 2 4 6 8 12m

FUTURE STREET  
FRONTAGE

FOURTH AVENUE

GURNER AVENUE

LEGEND



TOTAL TREE CANOPY COVERAGE AREA: 203.4M<sup>2</sup> (27%)



TREE CARPARK AREA: 754M<sup>2</sup>

